

AMERICAN HISTORICAL ASSOCIATION

THE NEW YORK HILTON & TOWERS

AMERICAS HALL I

JANUARY 2 - 5, 2009

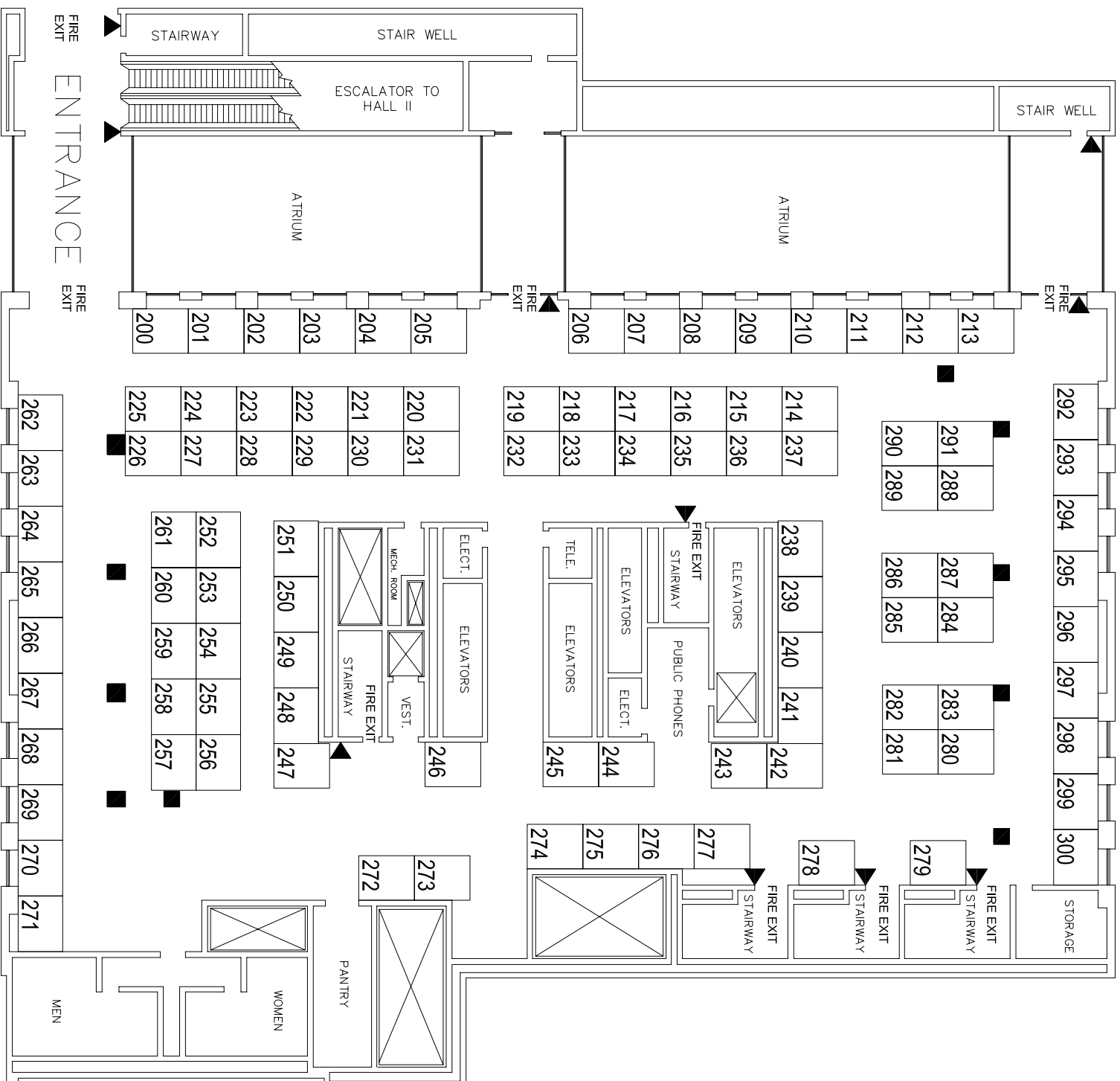

FIREHOSE CABINET
CEILING HEIGHT = 14'-6"

AM I as of 03/07/2008

Dimension	Size	Qty	SqFt
8'x10'	80	101	8,080
Totals:	80	101	8,080



Copyright © by GERS Exposition Services. All rights reserved. No part of this publication may be reproduced, stored in a retrieval system, or transmitted in any form by any means - electronic, mechanical, photocopying, recording, or otherwise - without the express written consent of GERS Exposition Services. This floor plan is tentative until it gets approval from the Facility and Fire Marshal.

Disclaimer: Every effort has been made to ensure the accuracy of all information contained on this floor plan. However, no warranties, either expressed or implied, are made with respect to this floor plan. If the location of building columns, utilities or other architectural components of the facility is a consideration in the construction or usage of an exhibit, it is the sole responsibility of the exhibitor to physically inspect the facility to verify all dimensions and locations.

AMERICAN HISTORICAL ASSOCIATION

THE NEW YORK HILTON & TOWERS

AMERICAS HALL II

JANUARY 2 - 5, 2009

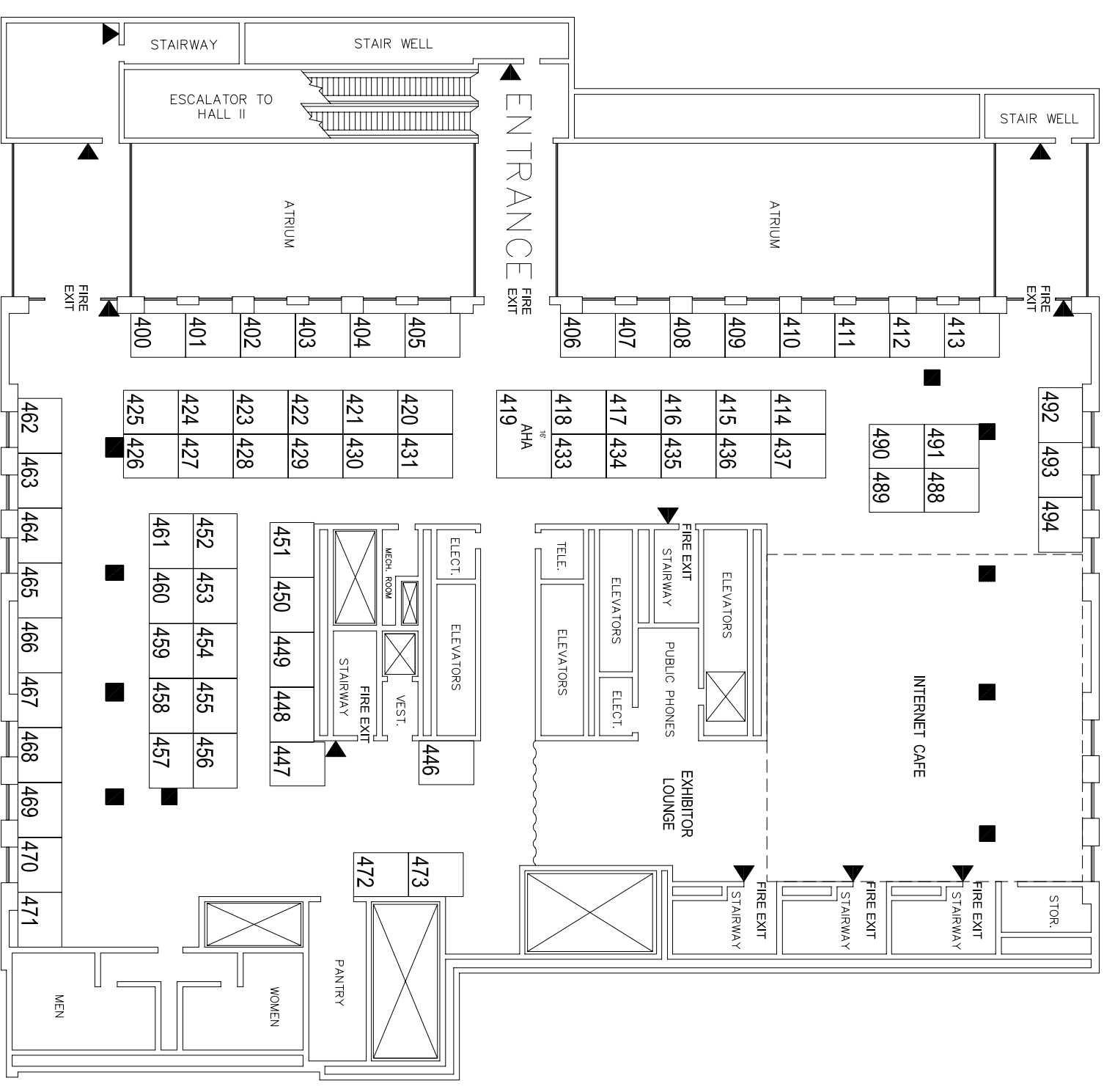

FIREHOSE CABINET
CEILING HEIGHT = 14'-6"

AM II as of 03/07/2008

Dimension	Size	Qty	SqFt
8'x10'	80	71	5,680
10'x16'	160	1	160
Totals:	80	72	5,840



Copyright © by GERS Exposition Services. All rights reserved. No part of this publication may be reproduced, stored in a retrieval system, or transmitted in any form by any means - electronic, mechanical, photocopying, recording, or otherwise - without the express written consent of GERS Exposition Services. This floor plan is tentative until it gets approval from the Facility and Fire Marshal.

Disclaimer: Every effort has been made to ensure the accuracy of all information contained on this floor plan. However, no warranties, either expressed or implied, are made with respect to this floor plan. If the location of building columns, utilities or other architectural components of the facility is a consideration in the construction or usage of an exhibit, it is the sole responsibility of the exhibitor to physically inspect the facility to verify all dimensions and locations.